

Enable Popups – Windows

GOOGLE CHROME

Click on settings icon (three lines or three dots) and then select **“Settings”**.

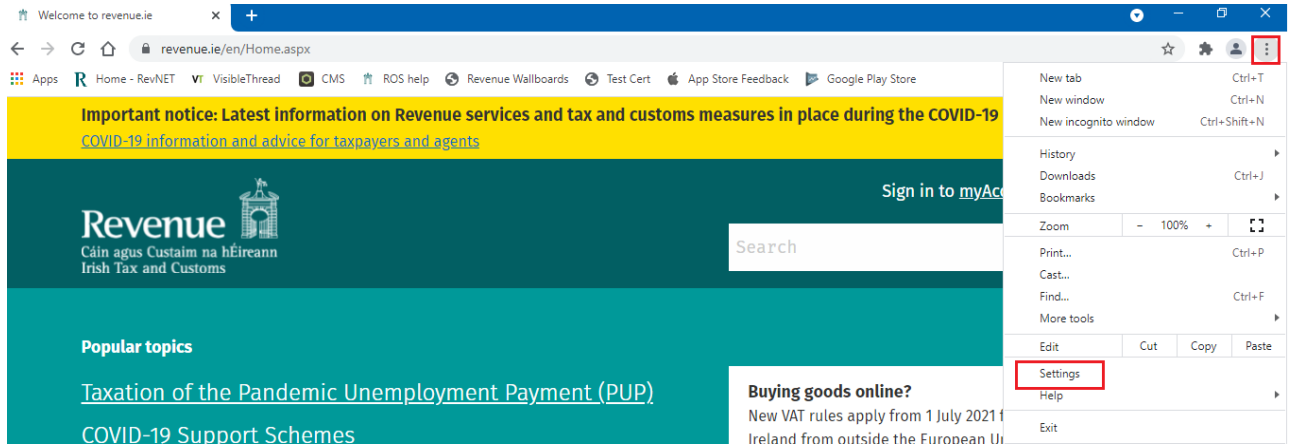

In Settings, click on **“Privacy and security”**.

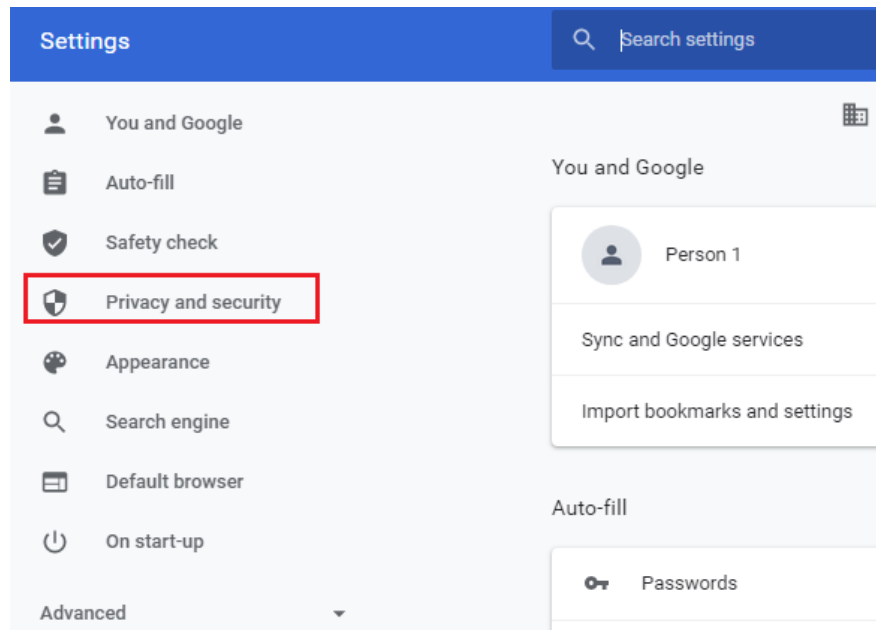

Scroll down and click on **“Site settings”**.

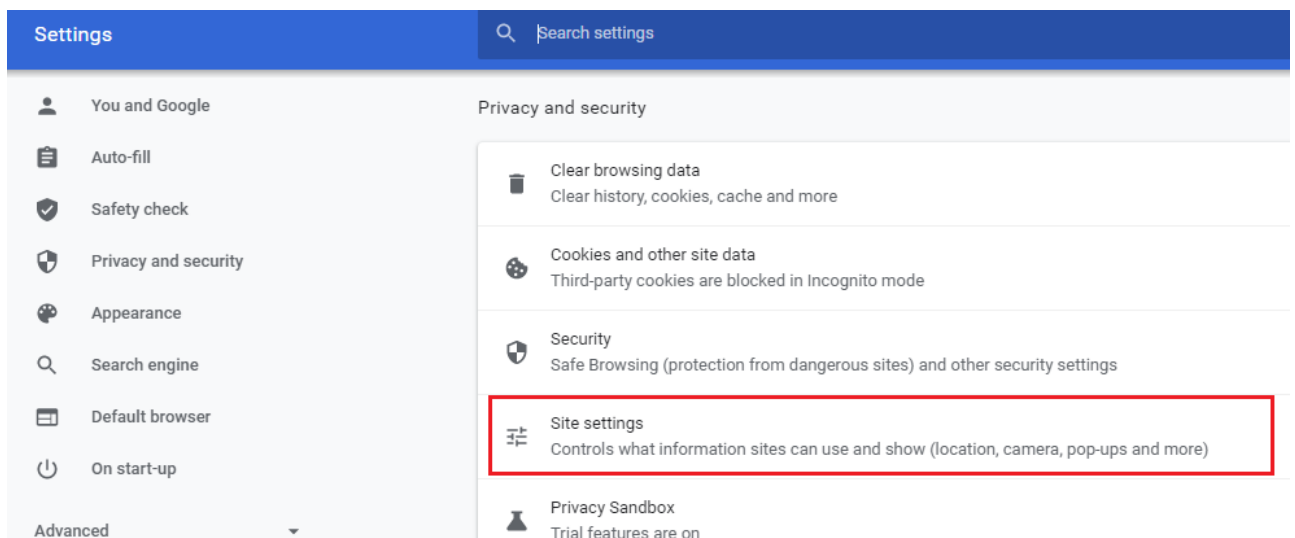

Click on **“Pop-ups and redirects”**.

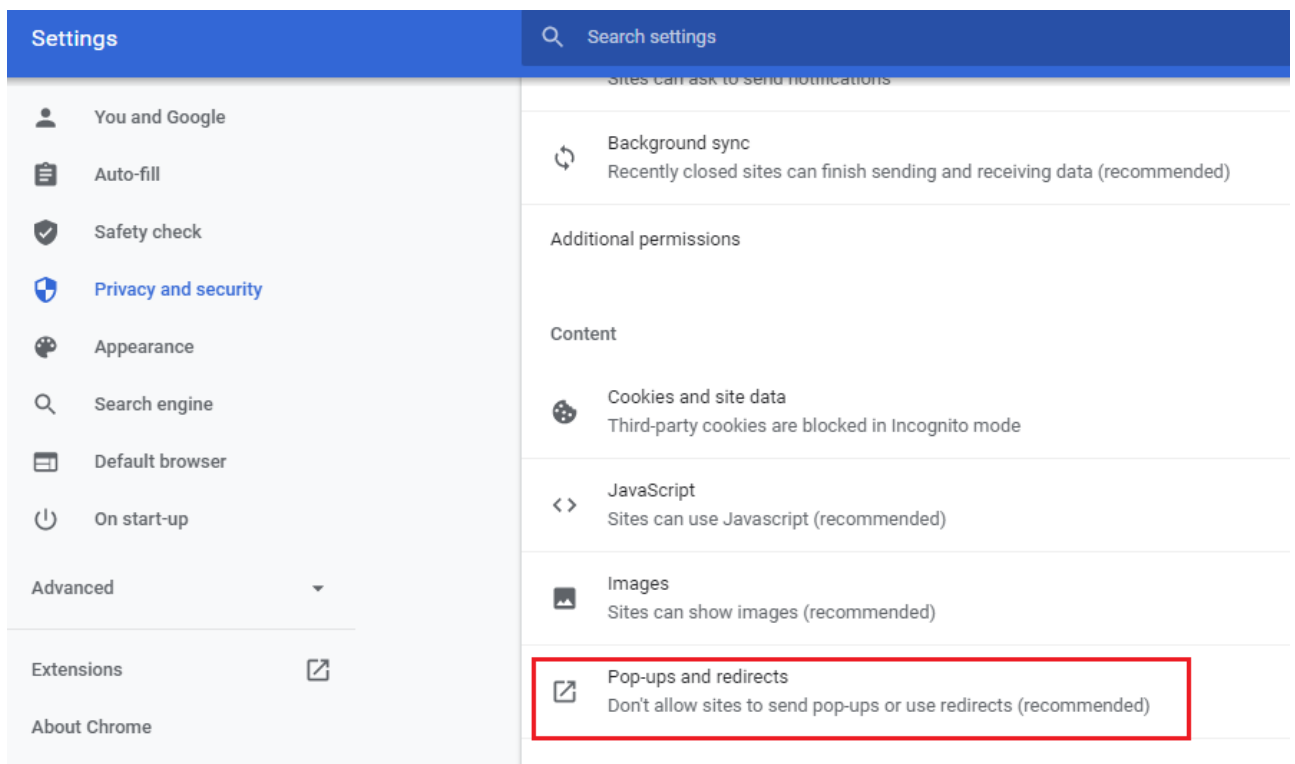

At **“Allowed to send pop-ups and use re-directs”**, click **“Add”**.

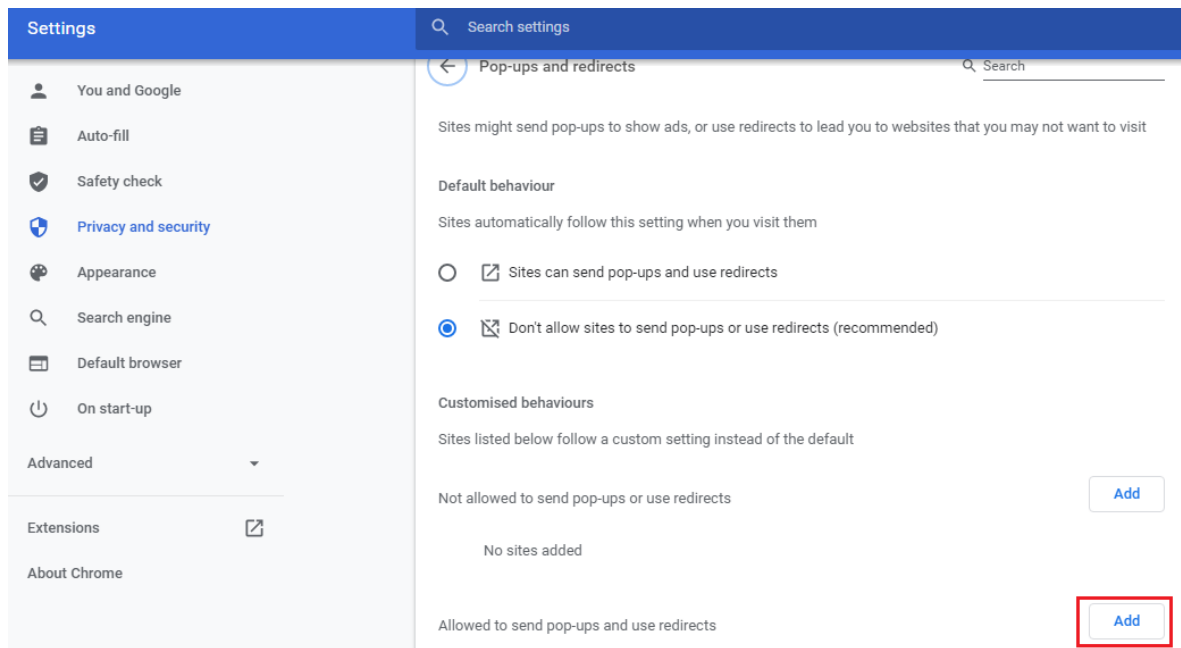

Enter <https://www.ros.ie> and click “Add”.

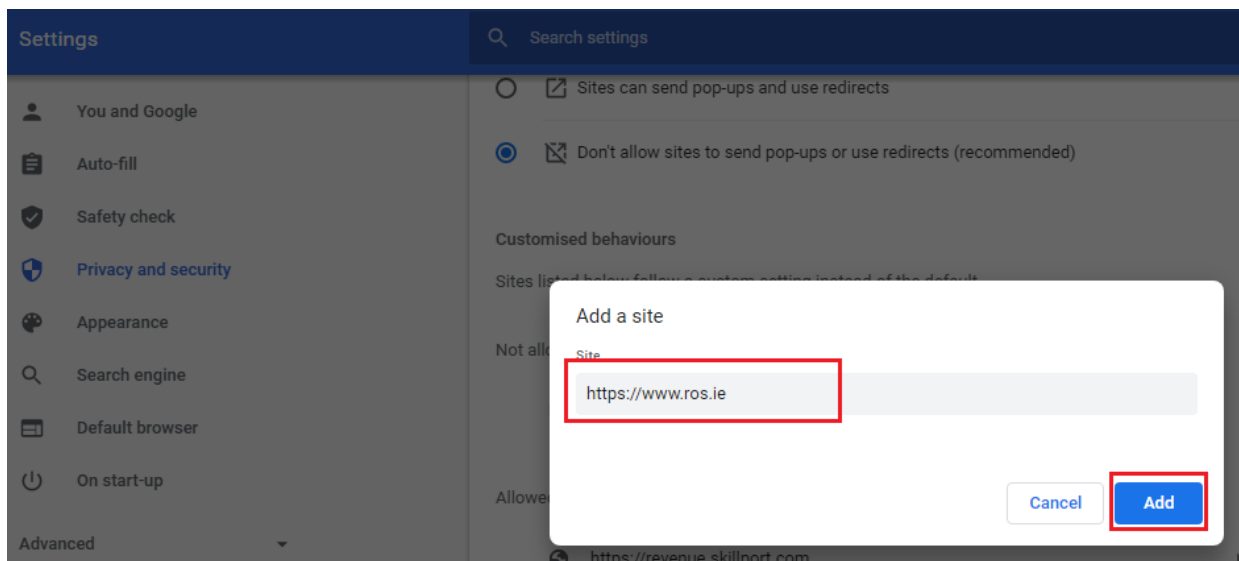

www.ros.ie is then added to the “Allowed” sites.

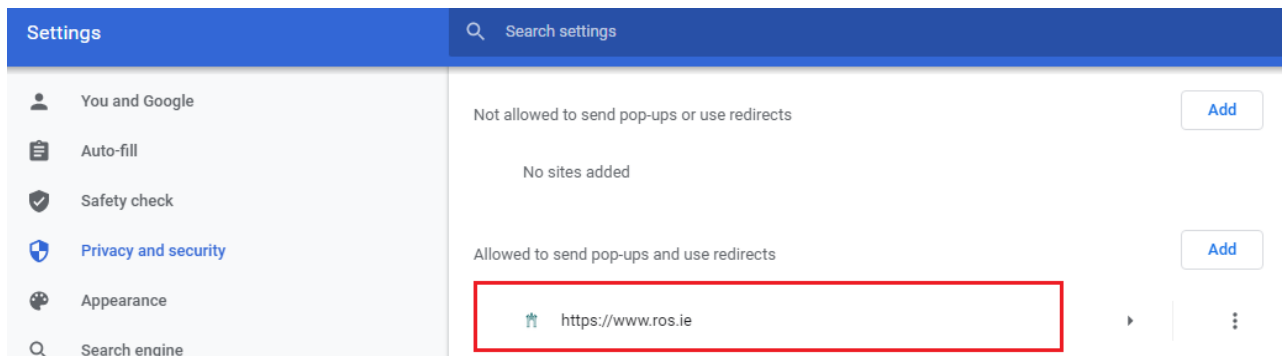

MICROSOFT EDGE

Click the three horizontal dots and select “Settings”.

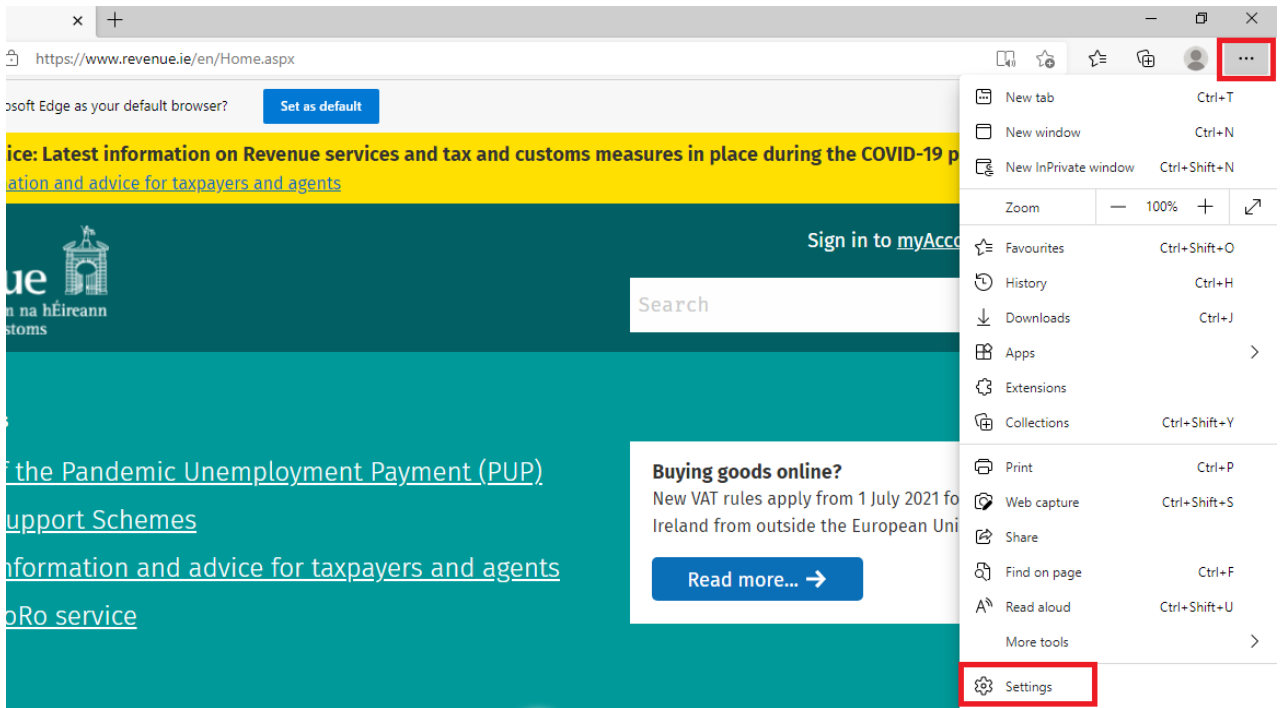

Click “Cookies and site Permissions” and then select “Pop-ups and redirects”.

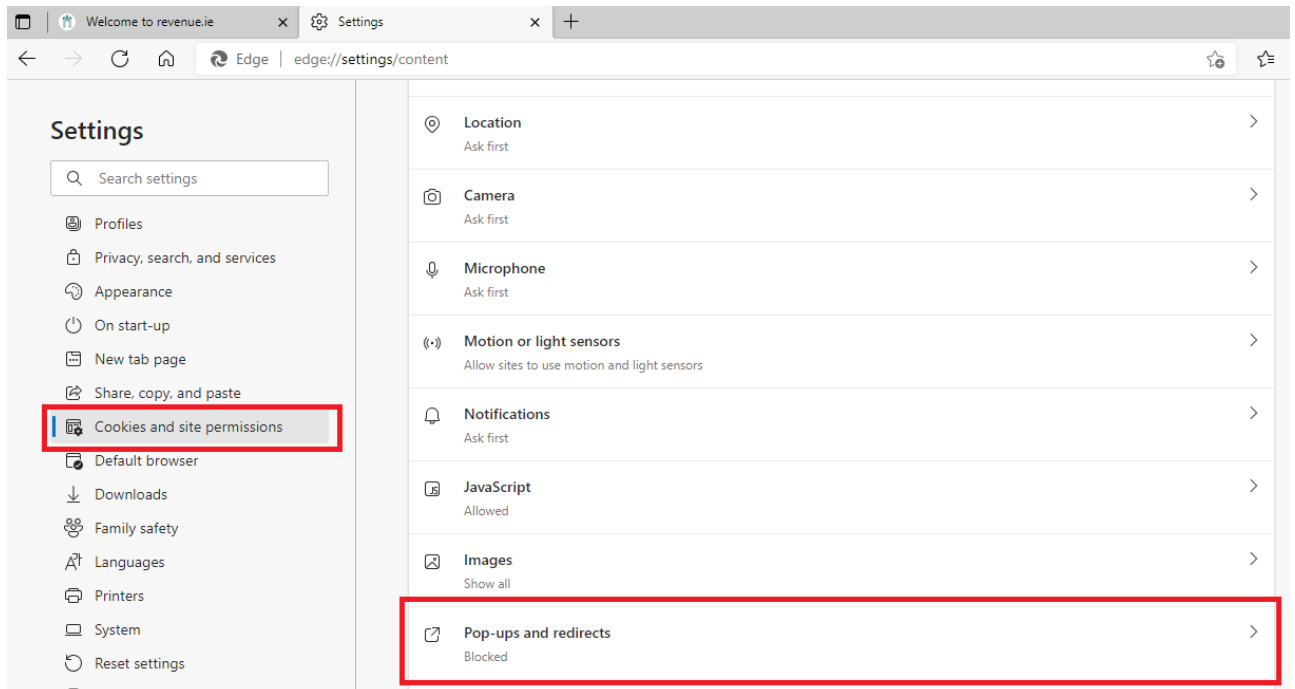

Click “Add” in the “Allow” section.

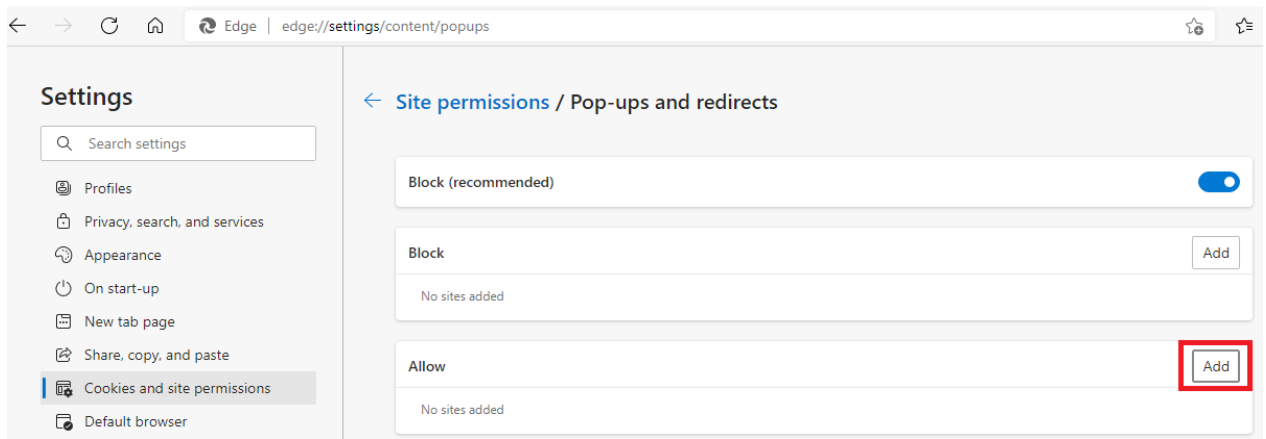

Type <https://www.ros.ie> into the “Site” input box and click **Add**.

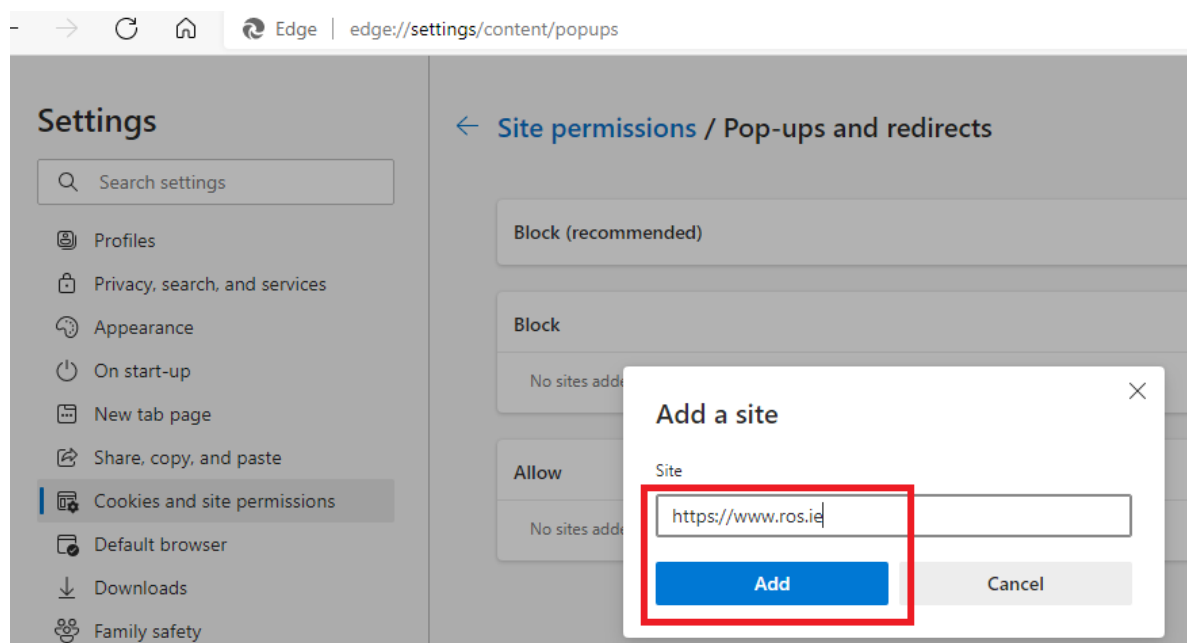

You should see that <https://www.ros.ie> has been added to the Allow list.

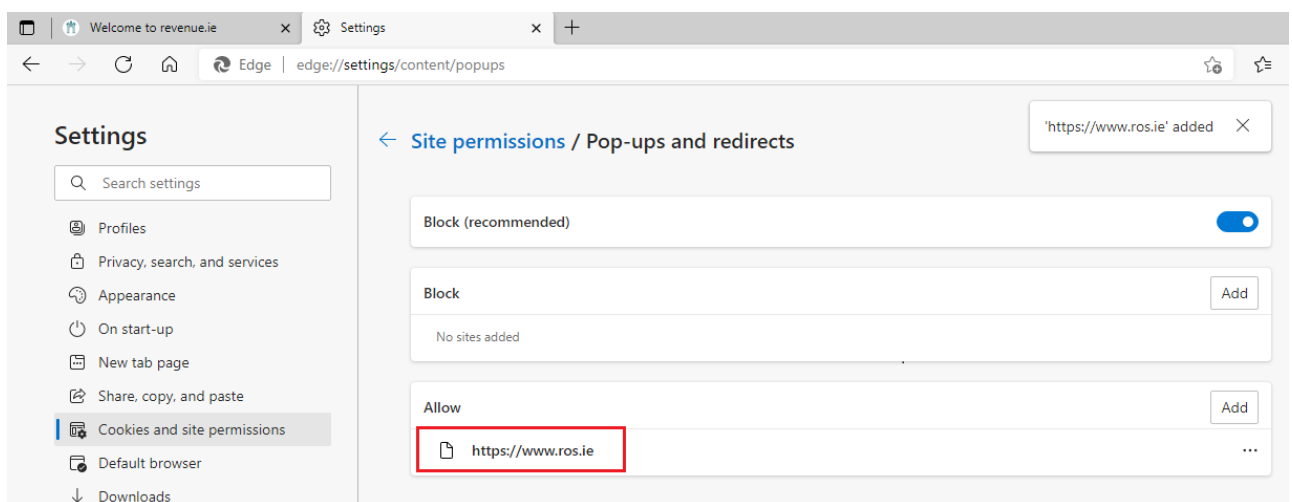

FIREFOX

From Tools menu select “Options”.

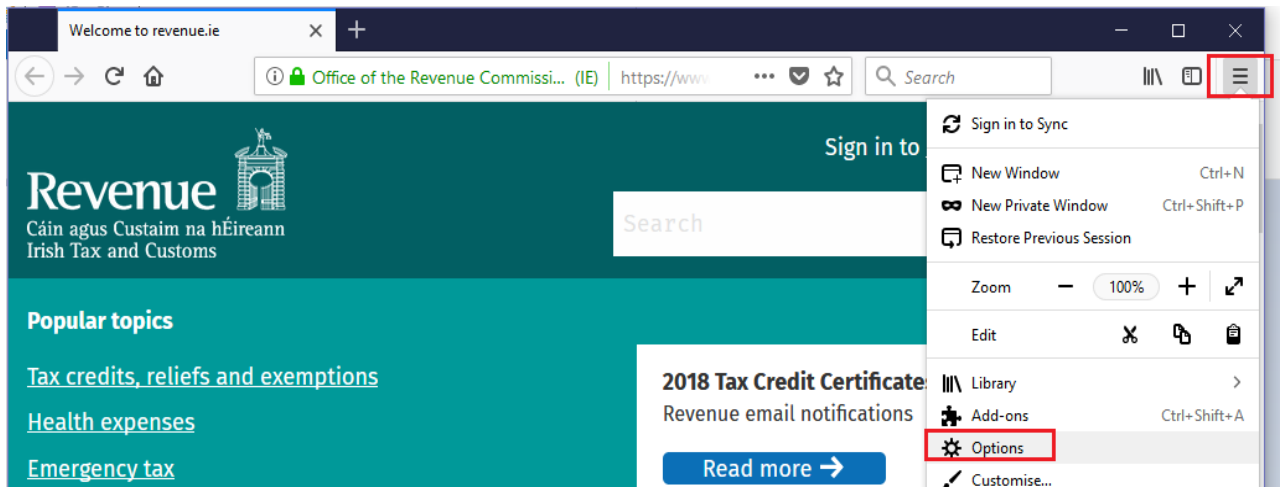

Click on “Privacy & Security” and scroll down to Permissions.

Click on “Exceptions” opposite the Block pop-up windows option.

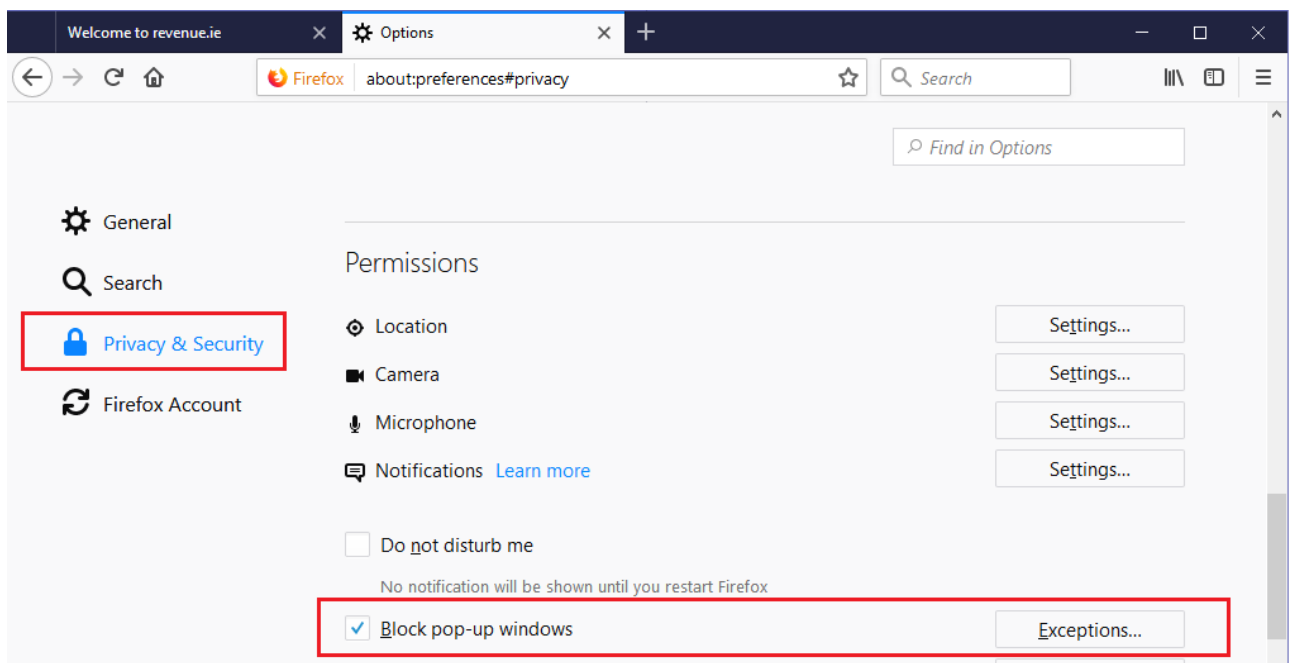

Type in <https://www.ros.ie> and click “Allow” and then “Save Changes”.

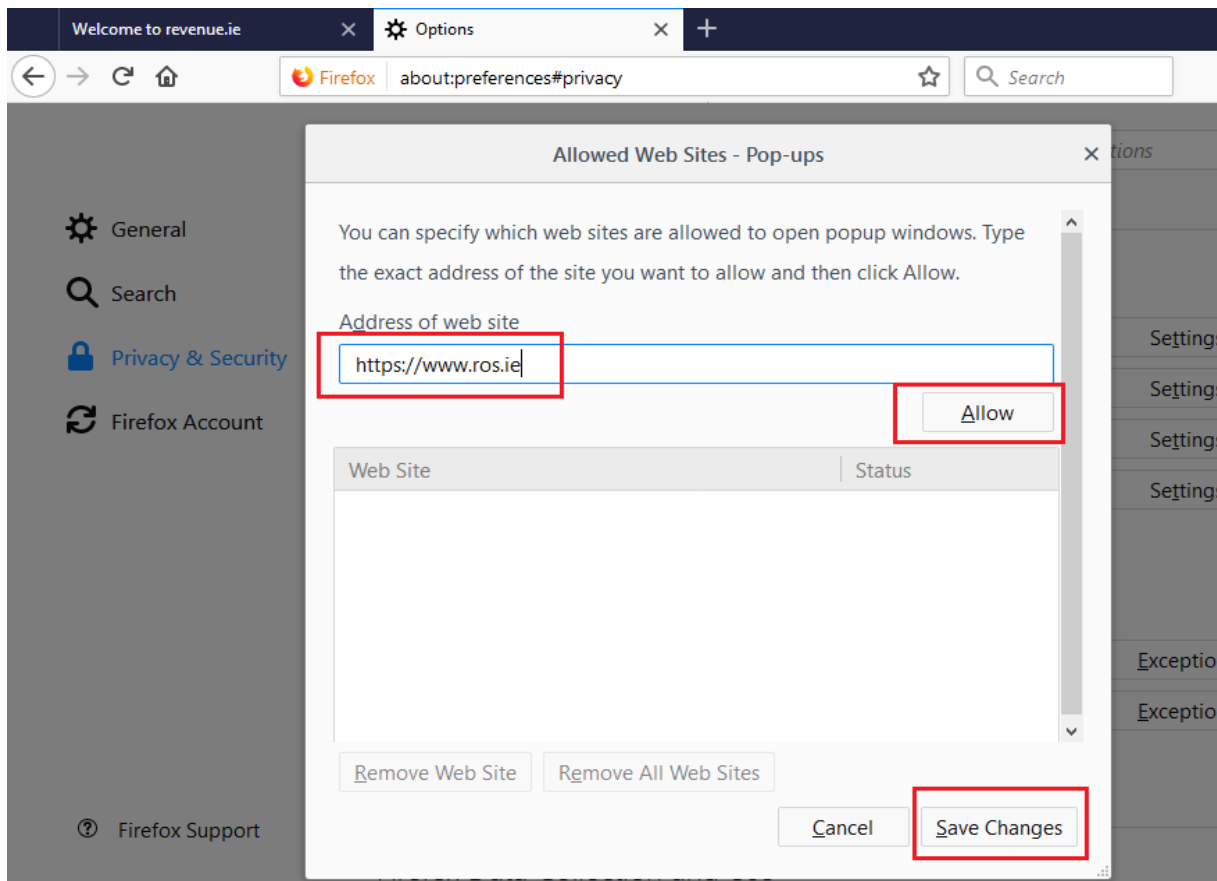

INTERNET EXPLORER

Select the Tools icon and then “Internet Options”.

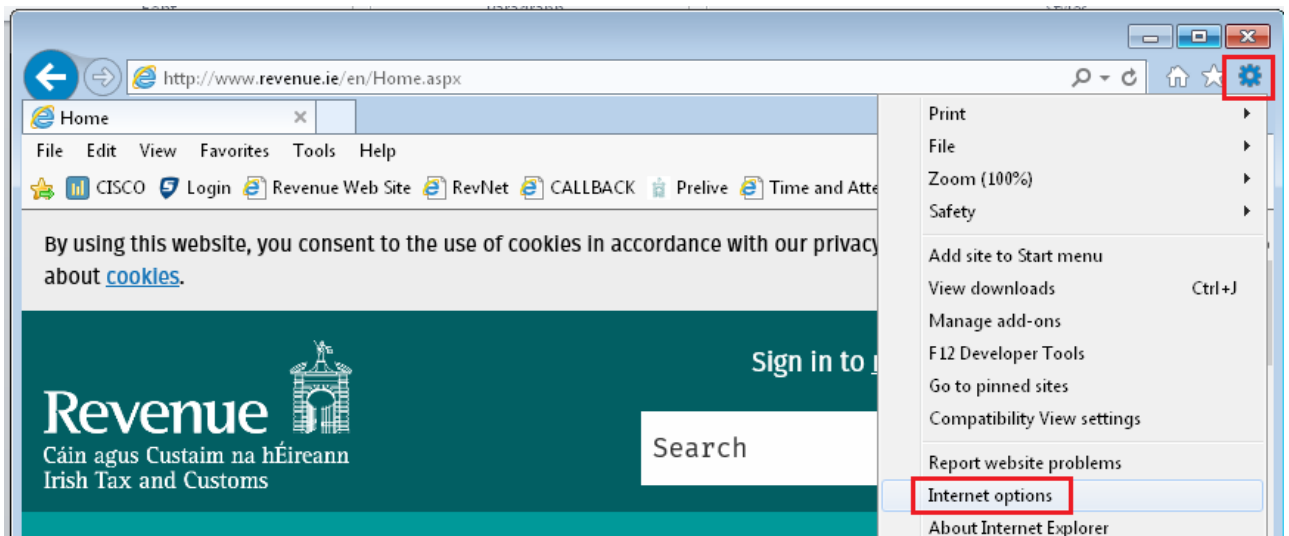

Click into the “Privacy” tab and click “Settings” beside Turn on Pop-up Blocker.
Enter <https://www.ros.ie> into the “Address of websites to allow” field, and click “Add”.

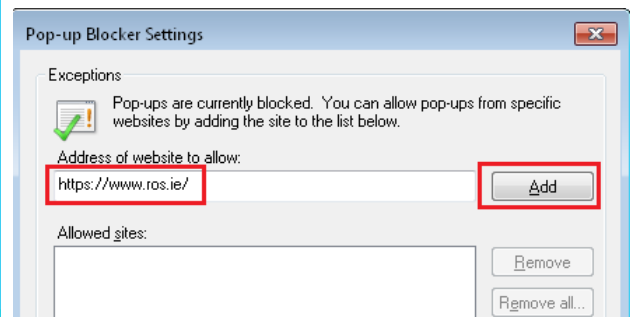
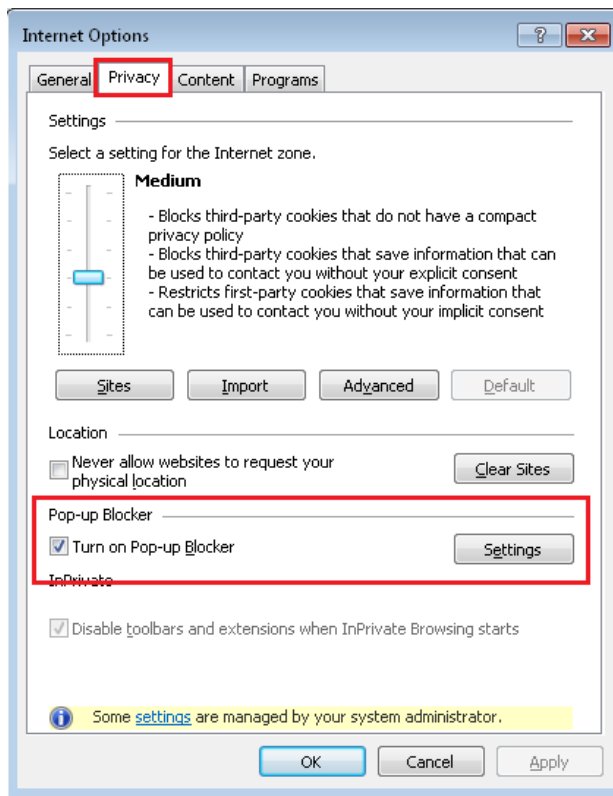

Welcome to revenue.ie x Options x +

Firefox about:preferences#privacy Search

Allowed Web Sites - Pop-ups

You can specify which web sites are allowed to open popup windows. Type the exact address of the site you want to allow and then click Allow.

Address of web site

Allow

Web Site	Status
https://www.ros.ie	Allow

Remove Web Site Remove All Web Sites

Cancel Save Changes

General Search Privacy & Security Firefox Account

Firefox Support

Settings... Settings... Settings... Settings... Exceptions... Exceptions...